

FOR THREE PHASE SAW (NOT SHOWN)

B-86 FRAME REST
 M-29 SWITCH TRIGGER
 M-34 SWITCH TRIGGER AXLE
 101450 SWITCH
 100690-9 MOTOR CORD
 103588 SWITCH ROD
 101350 SWITCH ROD POST

GIVE COMPLETE ELECTRICAL SPECIFICATIONS WHEN ORDERING MOTOR OR SWITCH

SERIAL NUMBER OF SAW MUST BE GIVEN WHEN ORDERING REPAIR PARTS

C. O. DATE		BY		NEXT ASSEMBLY		MODEL NUMBER		NUMBER REQUIRED	
						300			
THIS PART IS THE PROPERTY OF WELLS MANUFACTURING CORP. AND IS FURNISHED FOR INFO. DOES NOT CONVEY ANY RECOMMENDATION OR WARRANTY FROM WELLS MANUFACTURING CORP.									
FINISH: <input type="checkbox"/> NONE <input type="checkbox"/> PHOSPHATE <input type="checkbox"/> OIL <input type="checkbox"/> POLYMER <input type="checkbox"/> OTHER _____									
1. INSTRUCTIONS, A. 103564-1, ARE OBTAINED UNDER THIS PART. 2. THIS PART IS FOR USE ON THE THREE PHASE SAW ONLY. 3. THIS PART IS NOT TO BE USED ON ANY OTHER TYPE OF SAW. 4. THIS PART IS NOT TO BE USED ON ANY OTHER TYPE OF SAW.									
WELLS MANUFACTURING CORP., THREE RIVERS, MICH.					SCALE: *** DATE: 5/18/62 DRAWN BY: PH CHECKED BY: 5/17/62				
REPAIR PARTS LIST					MODEL 300 METAL SAW DATE REVISED: _____ PART NO. 103564				

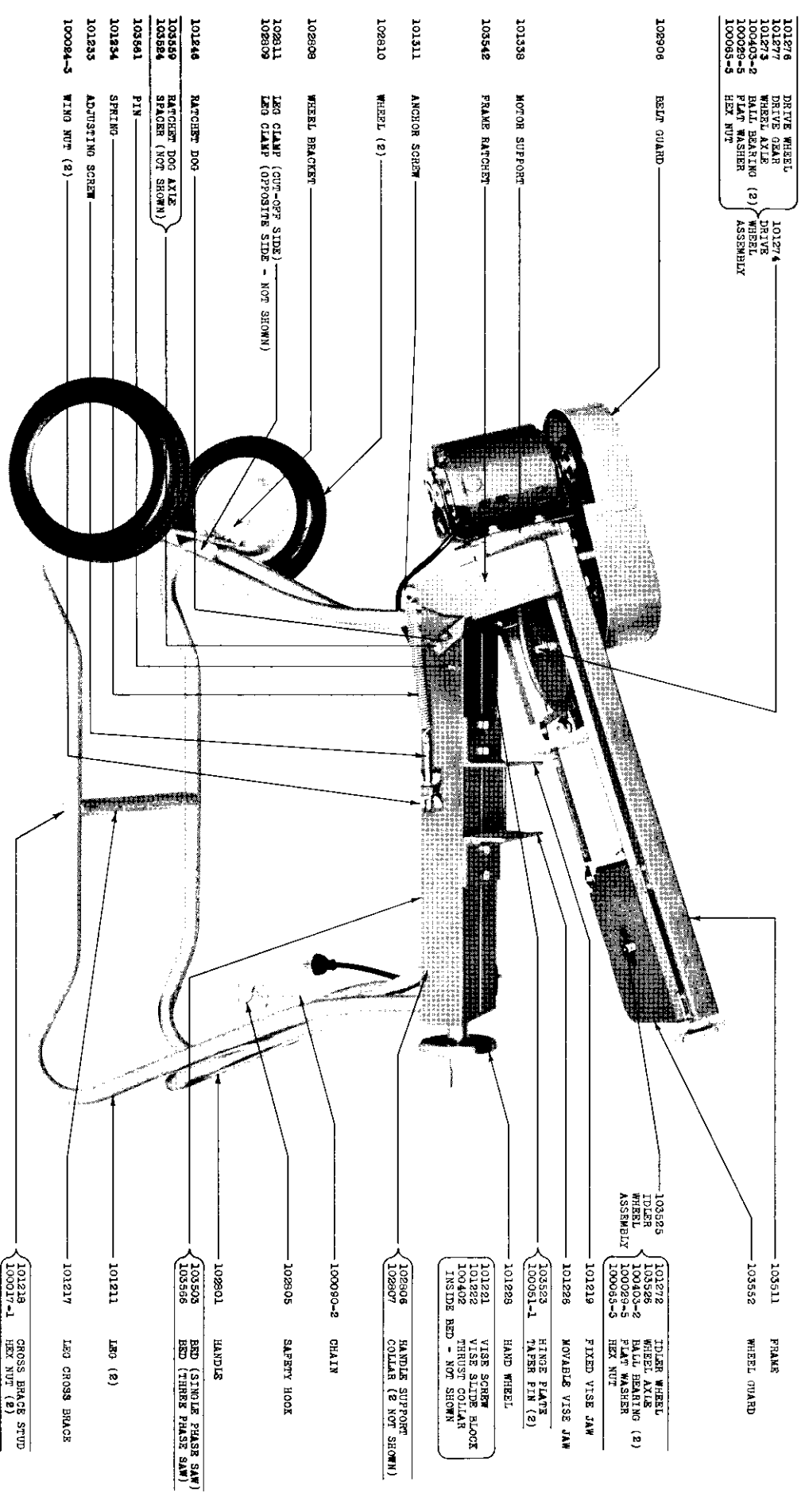

- 101276 DRIVE WHEEL
- 101277 DRIVE GEAR
- 101278 DRIVE WHEEL AXLE
- 100403-2 BALL BEARING (2)
- 100029-5 PLAIN WASHER
- 100095-5 HEX NUT

- 103511 FRAME
- 103552 WHEEL GUARD
- 103525 TIDLER WHEEL
- 101278 WHEEL AXLE
- 100403-2 BALL BEARING (2)
- 100029-5 PLAIN WASHER
- 100095-5 HEX NUT
- 101219 FIXED VISE JAW
- 101228 MOVABLE VISE JAW
- 103523 HINGE PLATE
- 100051-1 TAPER PIN (2)
- 101293 HAND WHEEL
- 101221 VISE SCREW
- 101222 VISE SLIDE BLOCK
- 100402 THRUST COLLAR
- INSIDE BED - NOT SHOWN

- 102906 HANDLE SUPPORT COLLAR (2 NOT SHOWN)
- 102907
- 100090-2 CHAIN
- 102905 SAFETY HOOK

- 102801 HANDLE
- 103503 BED (SINGLE PHASE SAW)
- 103566 BED (THREE PHASE SAW)

- 101218 GROSS REAR STUD
- 100017-1 HEX NUT (2)

- 102906 BELT GUARD
- 101338 MOTOR SUPPORT
- 103542 FRAME RATCHET
- 101211 ANCHOR SCREW
- 102910 WHEEL (2)
- 102908 WHEEL BRACKET
- 102911 LEG CLAMP (OPP. SIDE)
- 102909 LEG CLAMP (OPPOSITE SIDE - NOT SHOWN)
- 101248 RATCHET DOG
- 103549 RATCHET DOG AXLE
- 103524 RATCHET (NOT SHOWN)
- 103691 PIN
- 101254 SPRING
- 101233 ADJUSTING SCREW
- 100024-5 WING NUT (2)

GIVE COMPLETE ELECTRICAL SPECIFICATIONS WHEN ORDERING MOTOR OR SWITCH
 SERIAL NUMBER OF SAW MUST BE GIVEN WHEN ORDERING REPAIR PARTS

C. O. DATE		BY		NEXT ASSEMBLY		MODE NUMBER		NUMBERS REQUIRED	
						300			
WITH THIS IS THE PROPERTY OF WELLS MFG. CORP. AND IS LOANED TO YOU FOR REPAIR ONLY. IT IS TO BE RETURNED TO THE COMPANY AT THE END OF THE REPAIR PERIOD. IF YOU ARE NOT SURE OF THE RETURN DATE, CONTACT THE COMPANY FOR ASSISTANCE.									
FINISH SPECIFICATIONS SPECIFIED IN THE FOLLOWING NOTES MUST BE: 1. HEAT TREATING 2. HANDS 3. POLISH 4. ALL DIMENSIONS ARE TO BE TAKEN FROM THE NATIONAL BENCH MARK 5. ALL DIMENSIONS ON THIS DRAWING MUST BE HELD UNLESS OTHERWISE SPECIFIED.									
WELLS MANUFACTURING CORP., THREE RIVERS, MICH.									
SCALE: ***									
DATE: 5/13/52 BY: FR 5/17/52									
REPAIR PARTS LIST MODEL 300 METAL SAW DATE PRINTED: PART NO. 103564									